



TRG4

➤ MAIN FEATURES

- 20A switching capabilities.
- 4.5KV dielectric coil to contacts.
- Heavy load up to 5000VA.
- Applicable to motor switching.
- UL & cUL recognized.

➤ APPLICATIONS

- Air conditioner, Electronic heaters, Lamp and Motor control, Microwave oven Magnetron control Fax Machine/OA Equipment, etc.

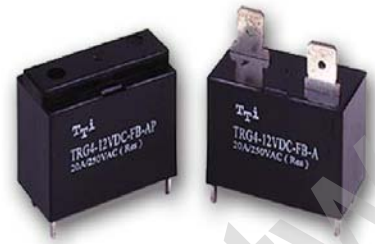

➤ ORDERING INFORMATION

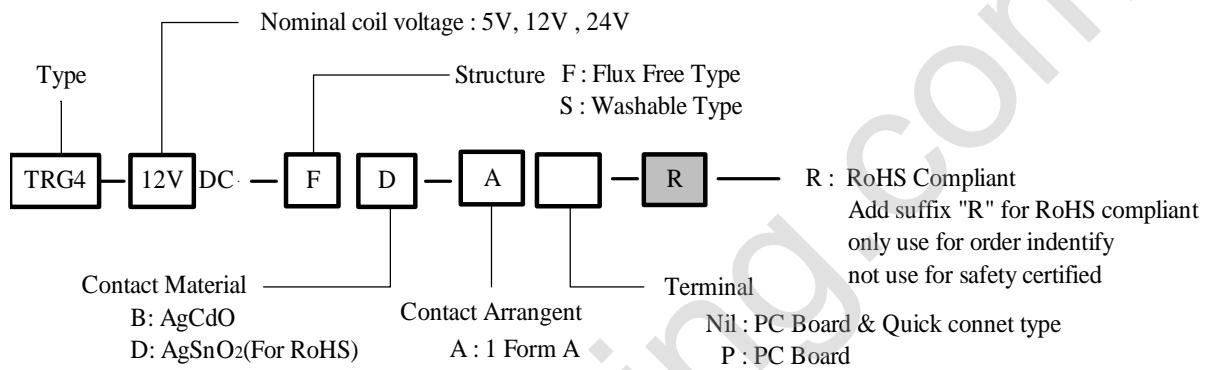

■ DIMENSION (unit:mm)

■ DRILLING (unit:mm)

■ WIRING DIAGRAM

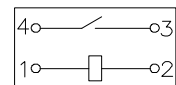
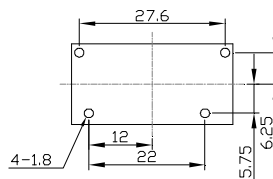
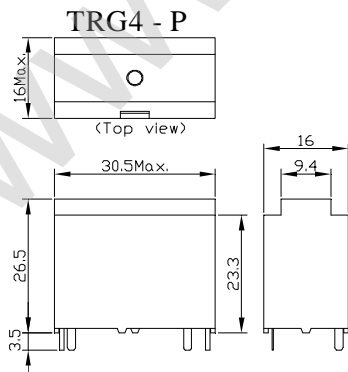
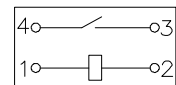
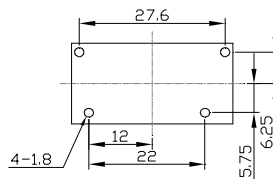
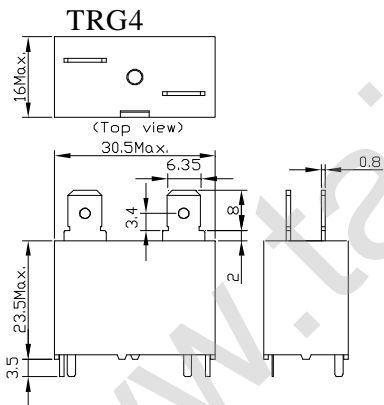

➤ **COIL DATA CHART**(at 20°C)

| Coil Sensitivity | Nominal Voltage (VDC) | Nominal Current (mA) | Coil Resistance (Ω) $\pm 10\%$ | Power Consumption (W) | Pull-In Voltage (VDC) | Drop-Out Voltage (VDC) | Max-Allowable Voltage (VDC) |
|------------------|-----------------------|----------------------|---|-----------------------|-----------------------|------------------------|-----------------------------|
| TRG4 | 5 | 179.8 | 27.8 | abt. 0.9W | 70% Max. | 10% Min. | 110% Max. |
| | 12 | 75 | 160 | | | | |
| | 24 | 37.5 | 640 | | | | |

➤ **CONTACT RATING**

| Item | Type | TRG4 |
|--------------------------------|------|--|
| Contact Capacity | | 20A 250VAC |
| Resistive Load (cos Φ =1) | | 2HP 240VAC 1HP 120VAC |
| Inductive Load | | Inrush : 80A , 0.3s (COS Φ =0.7) Break : 20A (COS Φ =0.9) |
| Rated Carrying Current | | 20A |
| Max. Allowable Voltage | | 250VAC |
| Max. Allowable Current | | 20A |
| Max. Allowable Power Force | | 5000VA |
| Contact Material | | Ag Alloy |

➤ **PERFORMANCE** (at initial value)

| Item | Type | TRG4 |
|-------------------------------|------|---|
| Contact Resistance | | 100m Ω Max (measured at 1A 6VDC). |
| Operation Time | | 20msec Max. |
| Release Time | | 10msec Max. |
| Dielectric Strength | | Between coil & contact Between contacts |
| Insulation Resistance | | 4500VAC, 1min 1000VAC, 1min |
| Operating Ambient Temperature | | 1000 M Ω Min. (500VDC) |
| Operating Humidity | | -25°C ~ +55°C |
| Vibration Resistance | | 85% , +40°C |
| Shock Resistance | | 10 to 55HZ Double Amplitude 1.5mm |
| Life Expectancy | | 196 m/s ² Malfunction. 980 m/s ² Mechanical. |
| Mechanically | | 2 × 10 ⁶ ops. Min. (18000PS/h) |
| Electrically | | 1 × 10 ⁵ ops. Min. |
| Weight | | Abt. 23grs. |
| UL & cUL | | E156406 |

➤ **REFERENCE DATA**

Contact Switching Capacity

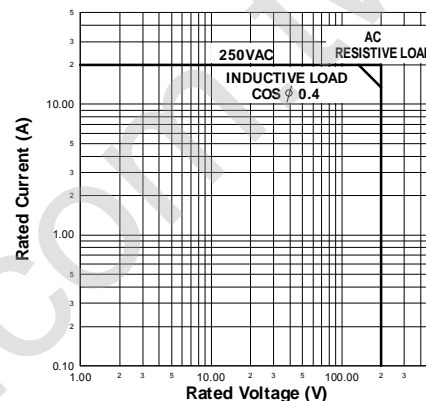

Life Curve

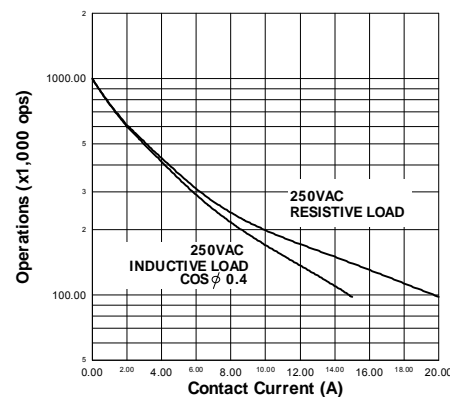

This datasheet for reference and subject to change without notice. Please double check final specification with Tai-Shing. (0939AA08VOL01)