

Water Solenoid Valve Specification

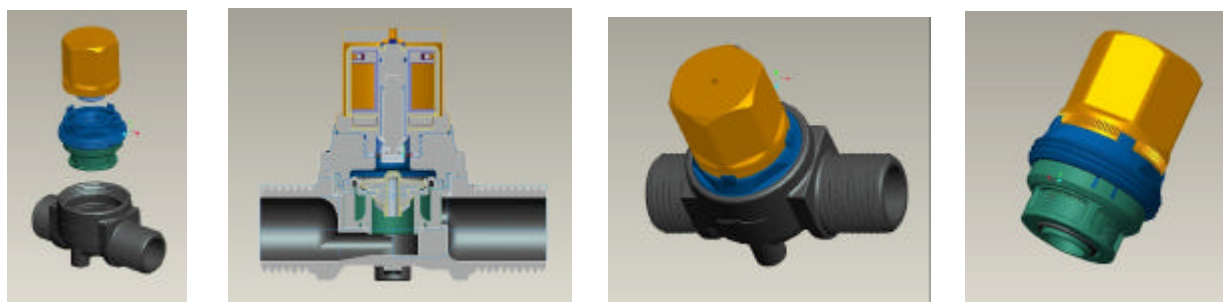

NO	SPEC ITEM	Content	Remark
1	Normal Voltage	12VDC	
2	Operating Power Consumption	7.2 W	
3	Salt (Sea) Water Application	Salt (Sea) Water compliance	
4	Ambient Temp. Range	1 - 40	
5	Working Water Temp	3.9~85.2	
6	Ambient Humidity Range	95 % RH max	
7	Valve Design Structure	Normal Close Type with Diaphragm	
8	Mechanic Life	Min 1,000,000 Cycles, Based on 10 sec on / 10 sec off at 3 Kgf / cm ²	
9	Coil Resistance	20 ± 7% ohm. (at 20)	
10	Valve Body Material	PPS	
11	Diaphragm Material	Silicon	
12	Spring Material	Stainless Steel	
13	Plunger Material	Stainless Steel	
14	Burst Pressure	500/psi	
15	Intake / Outlet Thread Size	1/2" N.P.S	
16	Flow Rate	min 6GPM at 3 Kgf/cm ² Dynamic Pressure	
17	Working Pressure Range	0.3Kgf/cm ² ~ 10Kgf/cm ² Static Pressure	
18	IP Level	Module match IP68 , Cable Connector IP65 min	
19	Valve Driving Voltage -- Open	12VDC ,at 10 Kgf/cm ²	
20	Valve Driving Voltage -- Close	0VDC ,at 0.2 Kgf/cm ²	